

# Short history campus planning and design

- Evolution of the university
- The unique American campus
- Current issues and trends

LSA 220 Fall 2014 , Richard Hawks





THE CHRONICLE OF HIGHER EDUCATION

# EVENTS



# IN ACADEME

A SPECIAL PULL-OUT SECTION

AUGUST 8, 1990/APRIL 30, 1991

- 970** Al-Azhar University, Cairo, Egypt
- 1100** University of Bologna, Italy
- 1170** University of Paris, France
- 1100's** Cambridge and Oxford, England

UNIVERSITES DE PARIS

PLACES  
DE LA  
VICTOIRE

1882





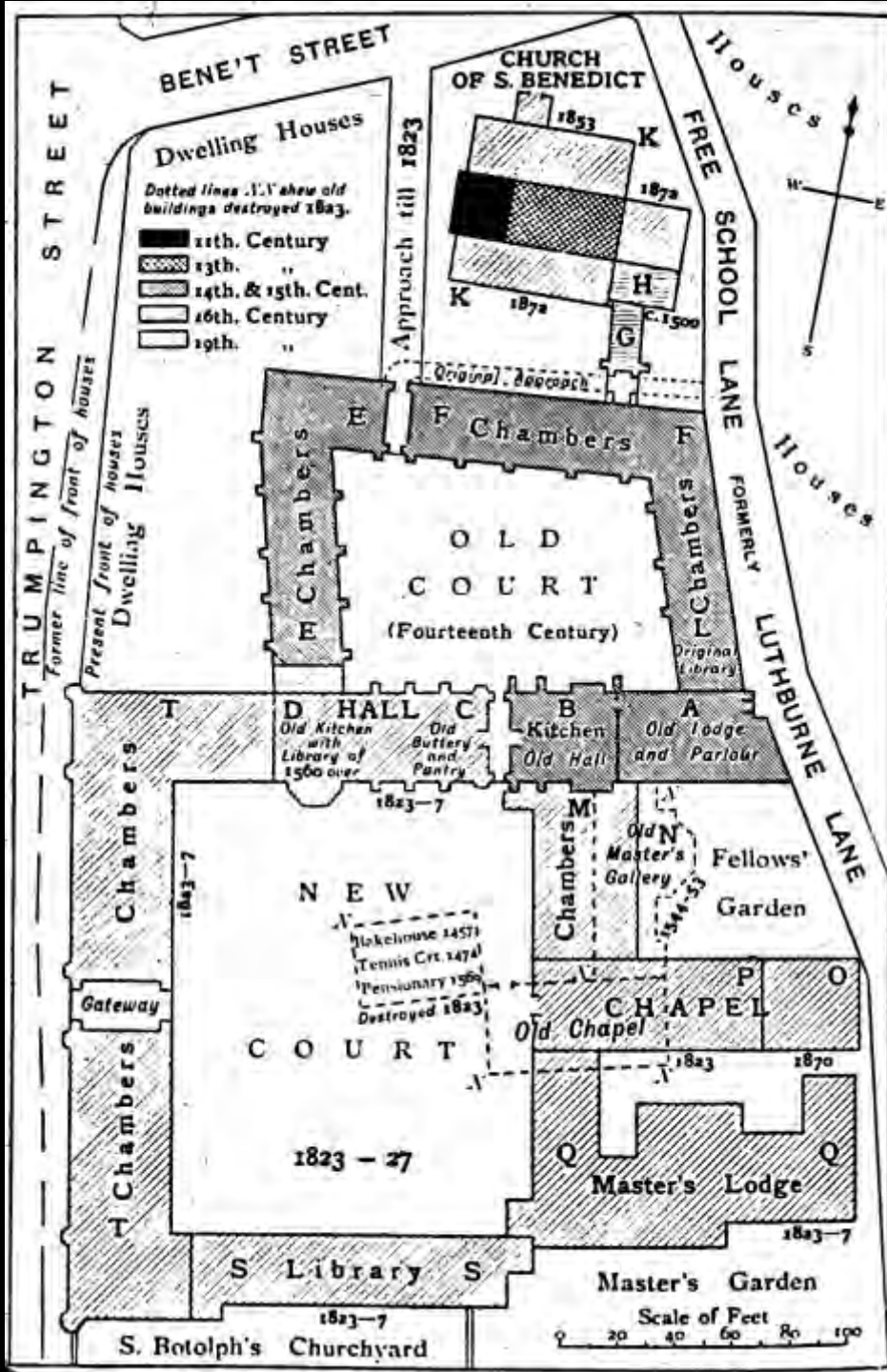



- 1538** University of Santo Domingo, Dominican Republic
- 1636** Harvard University
- 1693** William and Mary
- 1701** Yale
- 1746** Princeton
- 1754** Columbia
- 1756** University of Pennsylvania
- 1764** Brown
- 1766** Rutgers
- 1769** Dartmouth

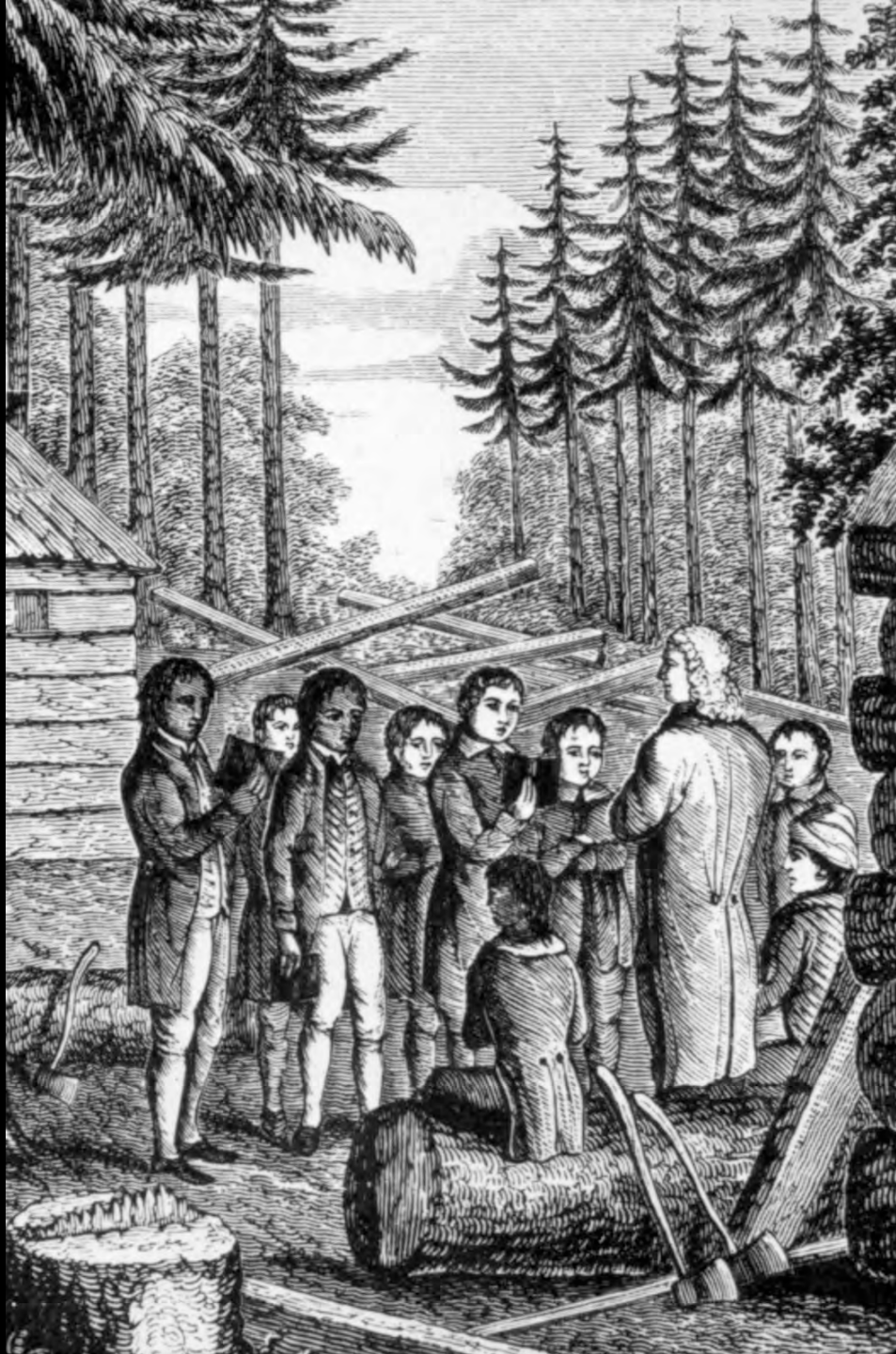



HARVARD, 1642

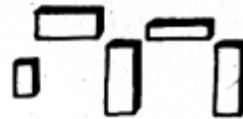

HARVARD, 1763



WILLIAM AND MARY, PLAN OF 1695

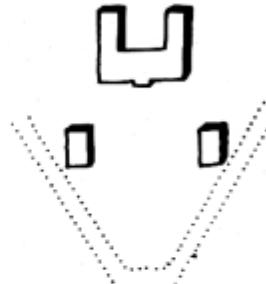

WILLIAM AND MARY, 1732

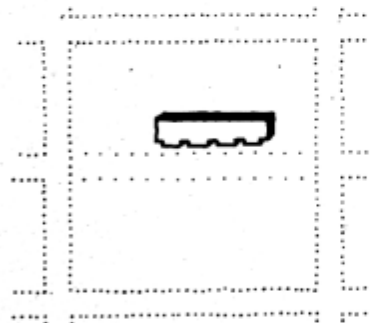

KING'S COLLEGE

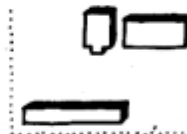

YALE, 1763



COLLEGE OF PHILADELPHIA



COLLEGE OF NEW JERSEY



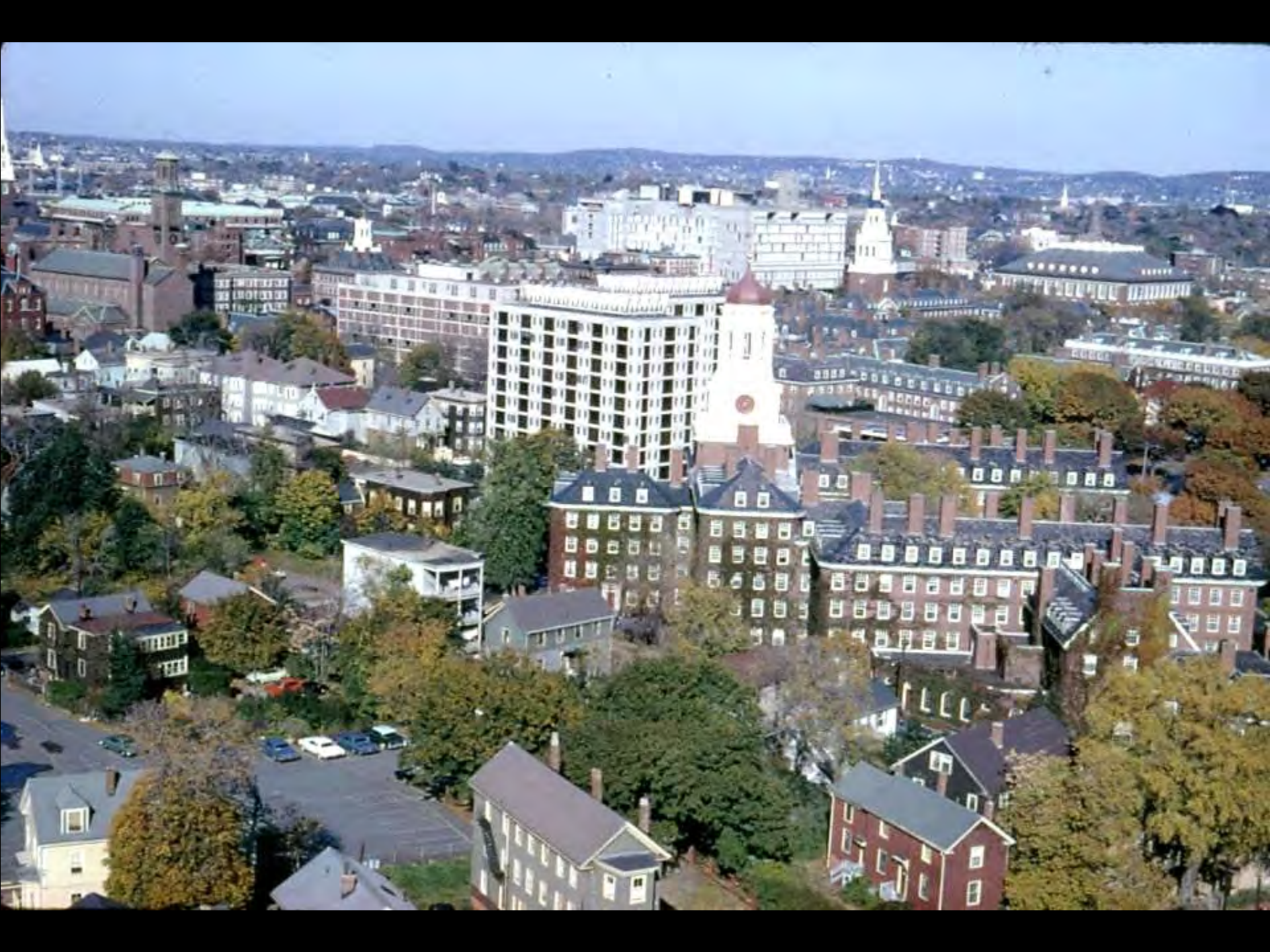

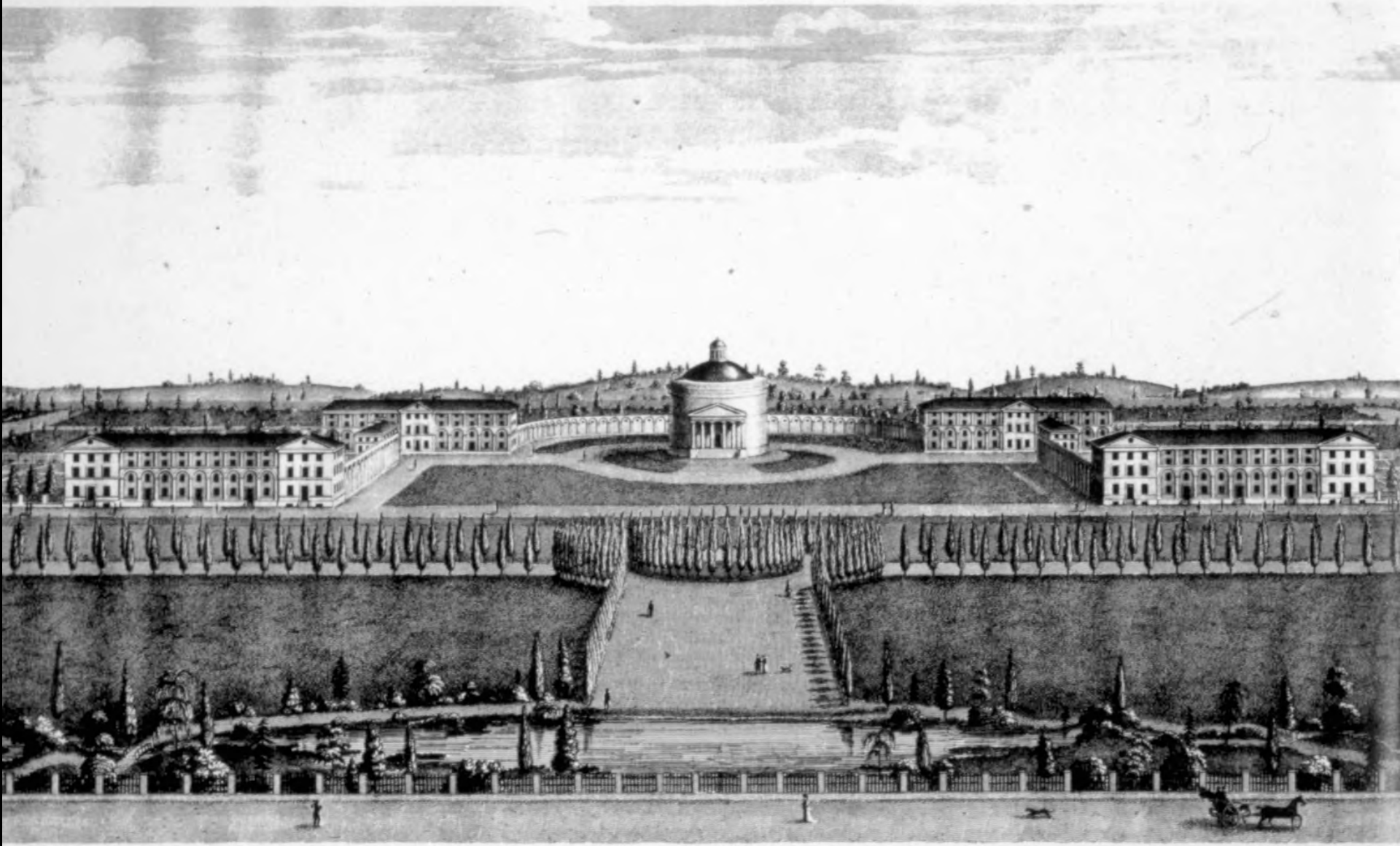









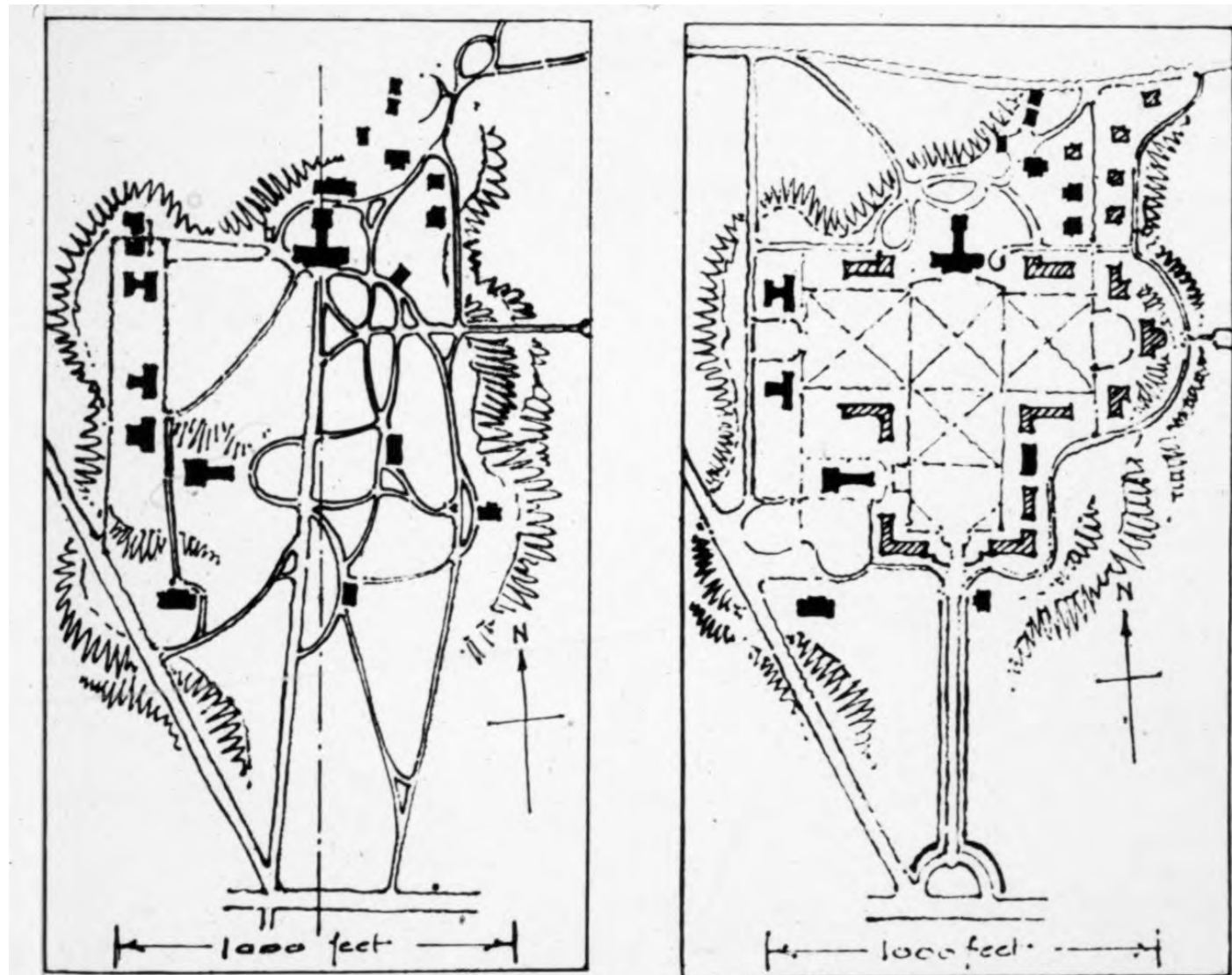

# To master plan or not to master plan



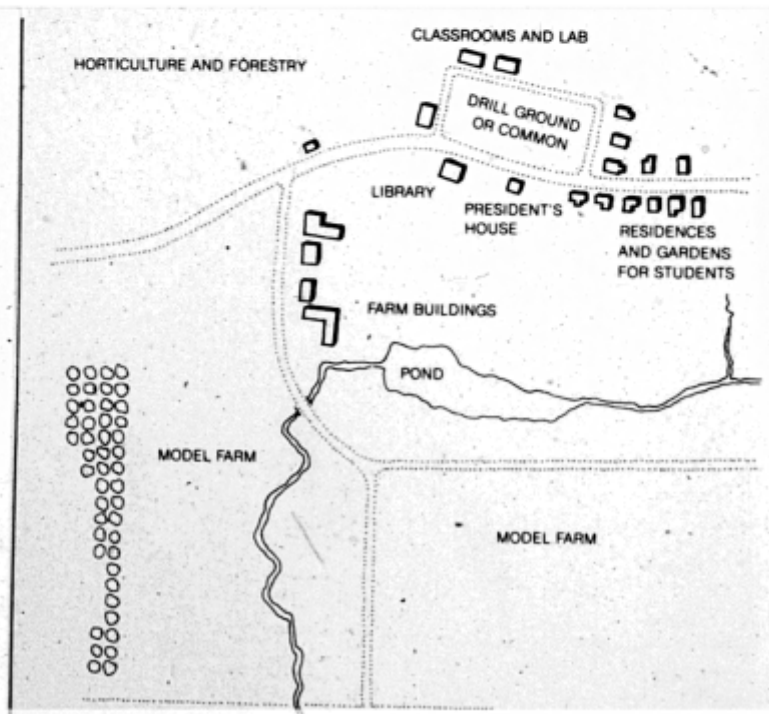
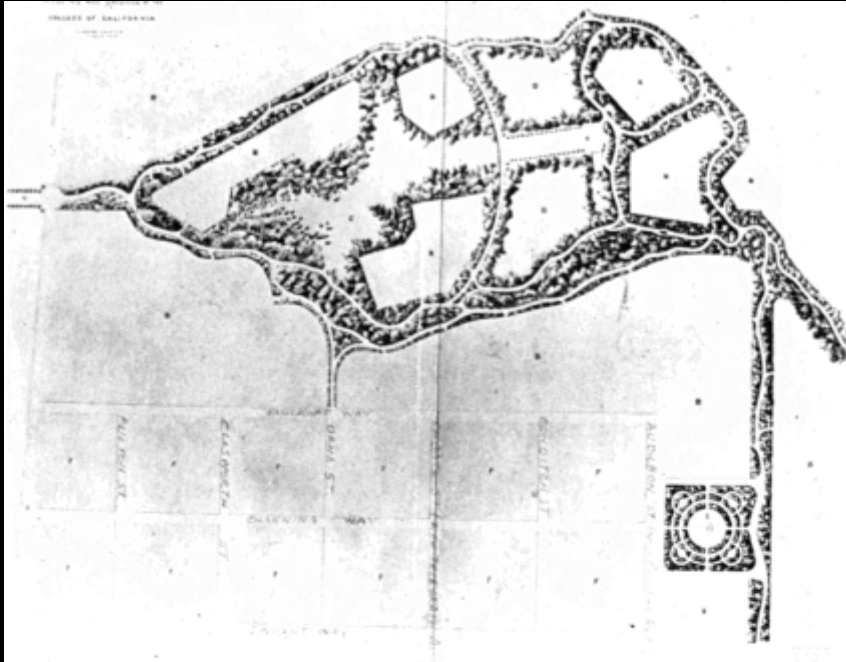



  
**Annual Budget**

  
**President's Tenure**

  
**Master Plan**

  
**Tree Maturation**

**YEARS**

0

50

100

**Typical cycles of campus elements reveals a complexity in time frames.**





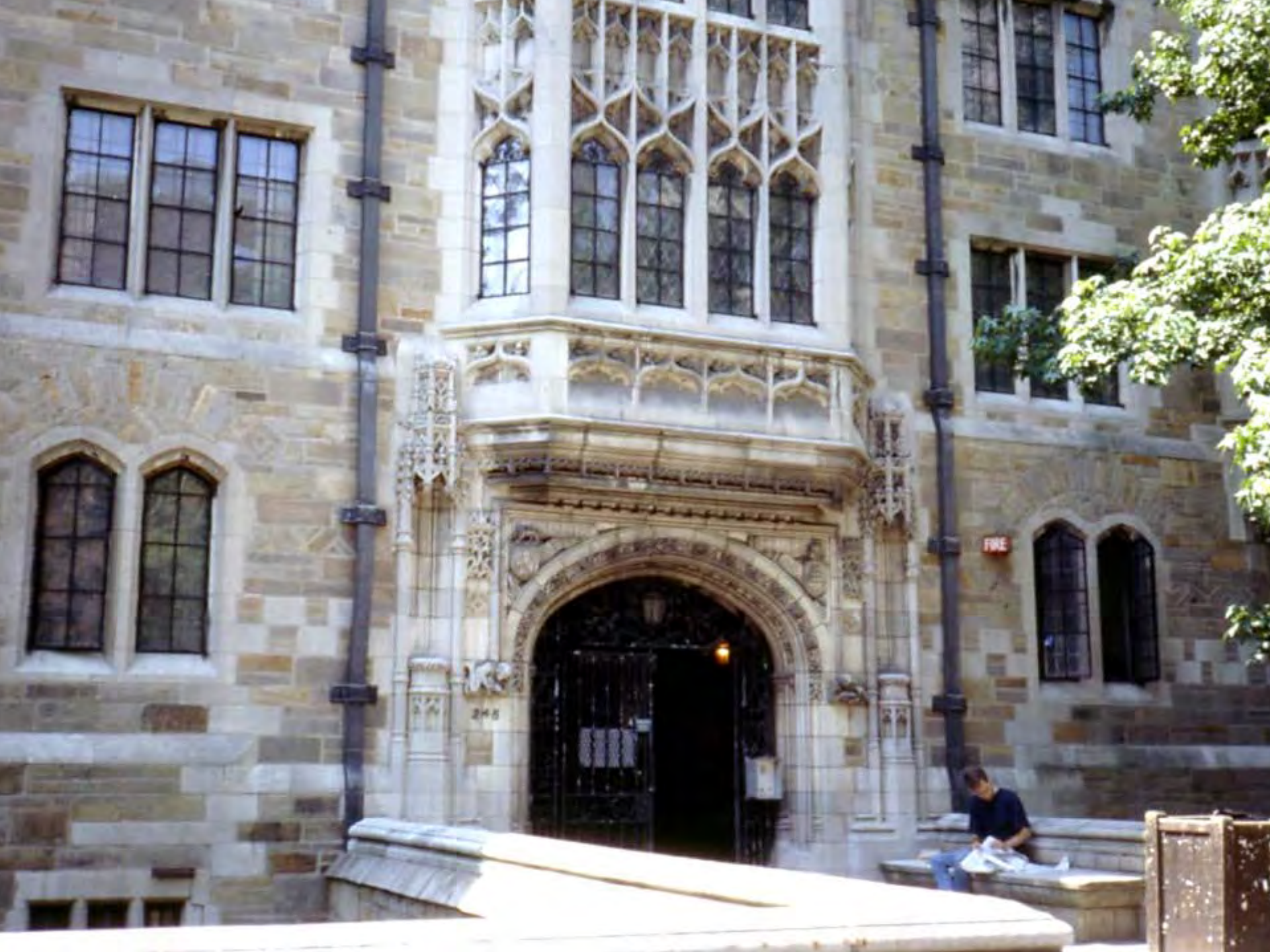

FIRE

245





# COMMUNITY/JUNIOR COLLEGE PLANNING

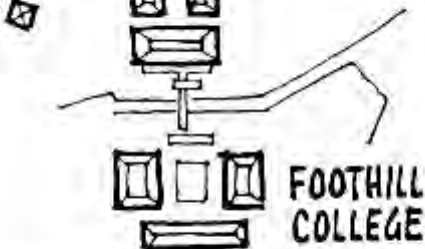
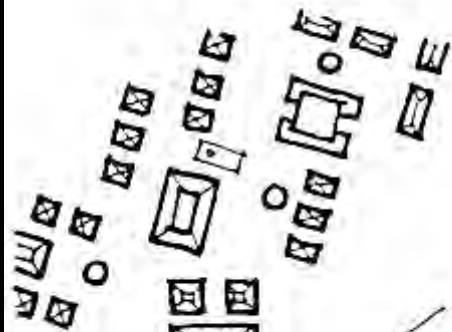

**FOOTHILL COLLEGE**

CALIFORNIA

Separate buildings - where climate encourages outdoor circulation

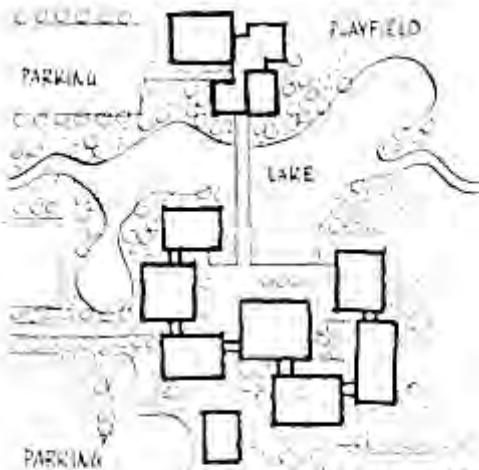

**EDISON COLLEGE**

FLORIDA

Linked buildings ... for convenience ... but allowing for incremental growth.

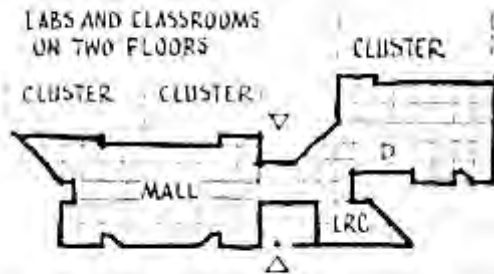

**OAKTON COMMUNITY COLLEGE**  
ILLINOIS

All facilities in a single building along a student mall.



**GRAND RAPIDS JUNIOR COLLEGE**  
MICHIGAN

The downtown college campus ... allowing for growth in stages ... with pedestrian bridges over city streets.





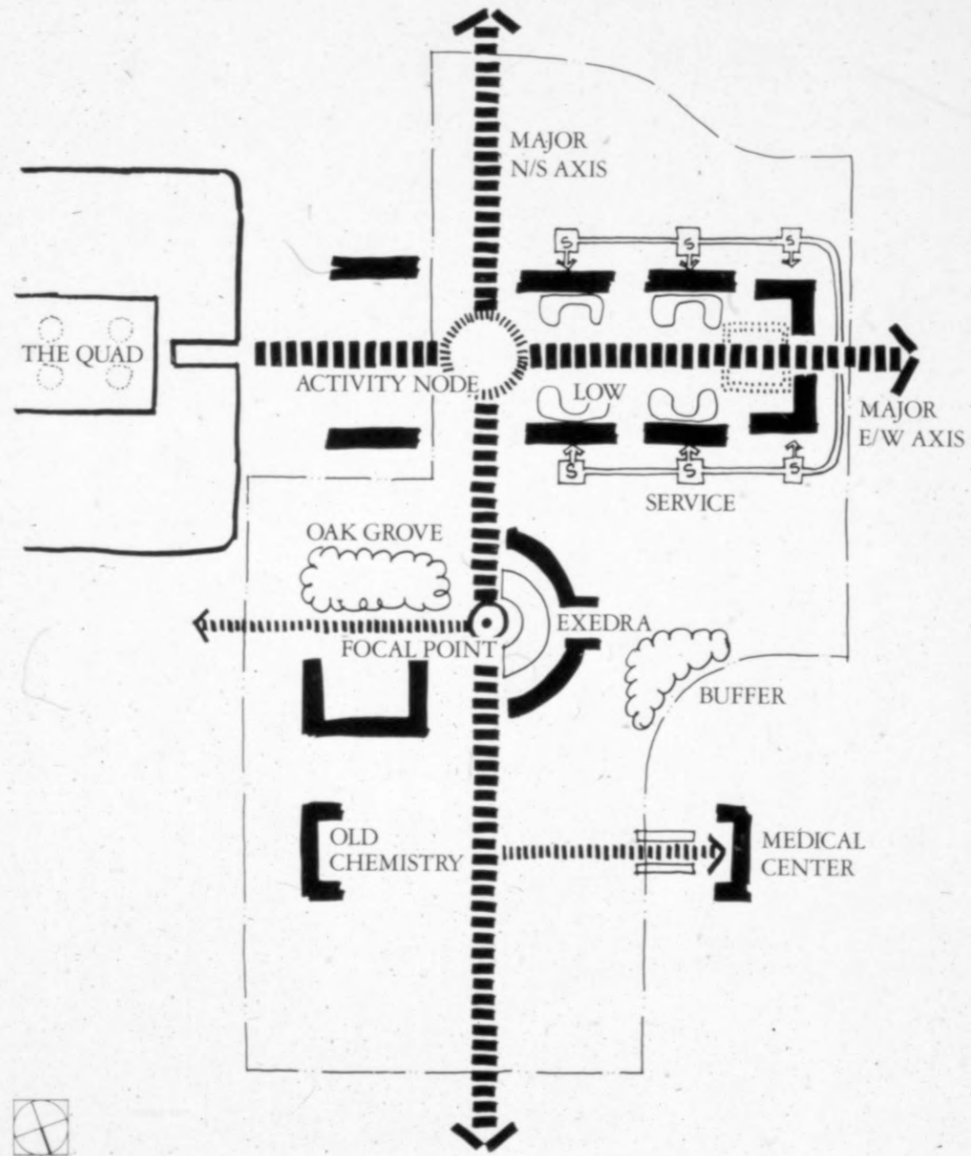

# Stanford University

- Grand Scale
- Response to climate
- Juxtaposition
- A place apart
- Permanence



- “fought the concept of unified campus...did not believe in pre planning entire campus or excessive formalism...let no building or space be dependent on its surroundings for success”  
Hudnut, Harvard 1940
- “stand alone buildings with no common denominator except quality”  
Griswald, Yale 1950’s







- “The tyranny of innovation is giving way to a new kind of historicism, pursued not for its own sake but for its wisdom. The return to Beaux Arts and even Jeffersonian principles in campus planning is not motivated by high brow taste for historical quotations but by common sense”

Joe Hibbard, Principal Sasaki Associates 1990's

# Campus design issues















## ROBIN HOOD OAK

THIS ENGLISH OAK GREW FROM AN ACORN  
BROUGHT FROM THE FAMOUS MAJOR OAK  
OF SHERWOOD FOREST IN ENGLAND BY  
PROFESSOR NELSON C. BROWN, CIRCA 1926.  
THE MAJOR OAK IS 10 FEET IN DIAMETER  
AND ABOUT 1000 YEARS OLD.

**College of the Holy Cross**  
**CAMPUS ARBORETUM**

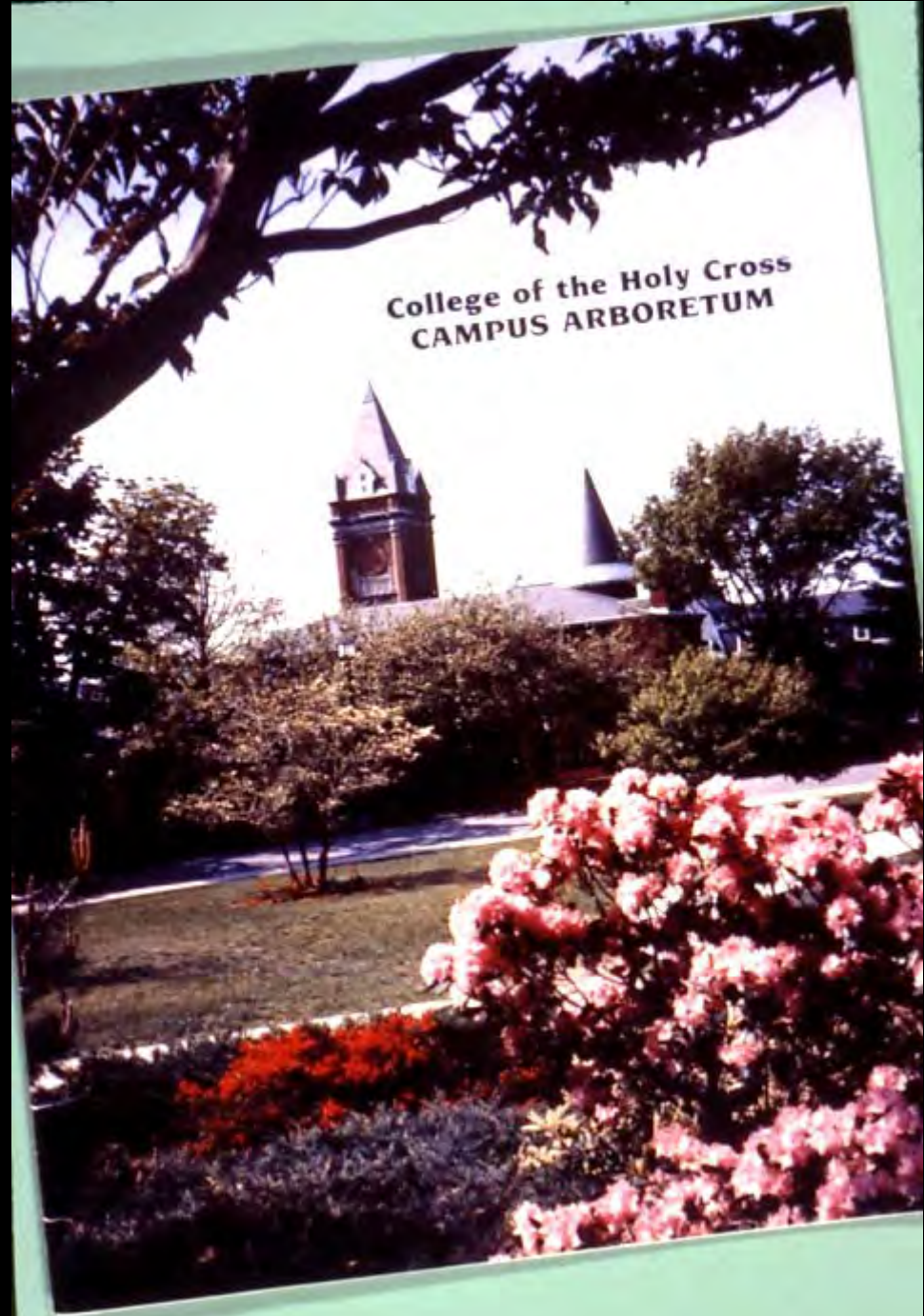







<p><b>Administrative Office</b></p> <p>College of Environmental Science and Forestry        100 College Road        Syracuse, NY 13210</p> <p><b>Special Units</b></p> <p>Center for Environmental and Estuarine Science        Center for Environmental and Estuarine Science        Center for Environmental and Estuarine Science        Center for Environmental and Estuarine Science        Center for Environmental and Estuarine Science        Center for Environmental and Estuarine Science        Center for Environmental and Estuarine Science        Center for Environmental and Estuarine Science        Center for Environmental and Estuarine Science        Center for Environmental and Estuarine Science</p>	<p><b>Academic Departments and Services</b></p> <p>Department of Biology        Department of Chemistry        Department of Earth and Atmospheric Sciences        Department of Environmental Science        Department of Forestry        Department of Geology        Department of Health, Behavior, and Society        Department of Life Science Education        Department of Plant Biology        Department of Public Health        Department of Soil and Water Conservation        Department of Toxicology        Department of Water Resources        Department of Wildlife Management        Department of Zoology</p>	<p><b>Administrative Offices</b></p> <p>College of Environmental Science and Forestry        Office of the President        Office of the Vice President for Academic Affairs        Office of the Vice President for Student Affairs        Office of the Vice President for External Affairs        Office of the Vice President for Financial Affairs        Office of the Vice President for Information Systems        Office of the Vice President for Legal Affairs        Office of the Vice President for Operations        Office of the Vice President for Planning        Office of the Vice President for Quality Improvement        Office of the Vice President for Safety        Office of the Vice President for Special Programs        Office of the Vice President for Technology        Office of the Vice President for University Relations        Office of the Vice President for Diversity and Inclusion        Office of the Vice President for Environmental Sustainability        Office of the Vice President for International Affairs        Office of the Vice President for Institutional Research and Assessment        Office of the Vice President for Marketing and Communications        Office of the Vice President for Research        Office of the Vice President for Student Success        Office of the Vice President for Title IX Compliance        Office of the Vice President for University Compliance        Office of the Vice President for University Governance</p>
--	--	---

# State University of New York College of Environmental Science and Forestry



Please - remember  
the handicapped!

DO NOT SECURE  
BICYCLES ON  
RAILING









AMNESTY  
INTERNATIONAL



GROUP NO. 387 (848-5867)



COMMITTEE FOR  
KOREA  
STUDIES



CKS









THIS GROUP OF  
WHITE PINE TREES  
DEDICATED TO THE MEMORY OF  
**DR. CHARLES E. BESSEY**  
BOTANY AND ZOOLOGY

1870

1882

VICE PRESIDENT

1883

1884

DEDICATED JUNE 6 1947











Campus  
Drive

# Willow Biomass



## HISTORY

Willow biomass has a long history of use in various industries. It is a fast-growing, renewable resource that can be used for a variety of purposes, including energy production, paper manufacturing, and construction. The use of willow biomass as a sustainable energy source has gained significant attention in recent years due to its low carbon footprint and ability to be grown on marginal lands.



## FUNCTION

Willow biomass is a versatile resource that can be used in several ways. It can be used for energy production through direct combustion or gasification. It can also be used for the production of bioethanol and other bio-based products. Additionally, willow biomass can be used for construction materials, such as particleboard and OSB. The use of willow biomass as a sustainable resource is a key component of many green initiatives and circular economy models.

Willow biomass is a fast-growing, renewable resource that can be used for a variety of purposes, including energy production, paper manufacturing, and construction. The use of willow biomass as a sustainable energy source has gained significant attention in recent years due to its low carbon footprint and ability to be grown on marginal lands.



ESF's Wood Bioprocessing System

## FUTURE

The future of willow biomass is bright. As the world moves towards a more sustainable and circular economy, willow biomass is expected to play an increasingly important role. Continued research and development will further optimize the production and use of willow biomass, making it an even more attractive and viable option for sustainable energy and materials.















# Campus as community







Residential Site



# CENTENNIAL CAMPUS

NORTH CAROLINA STATE UNIVERSITY

AN IMAGE OF OUR SECOND CENTURY



A UNIVERSITY & INDUSTRY PARTNERSHIP



# University of Cincinnati – Master Plan

“Following a brilliant master plan by landscape architect[s Hargreaves Associates], that campus heart now beats 24/7.”

Blair Kamin, Chief Architecture Critic  
*Chicago Tribune*

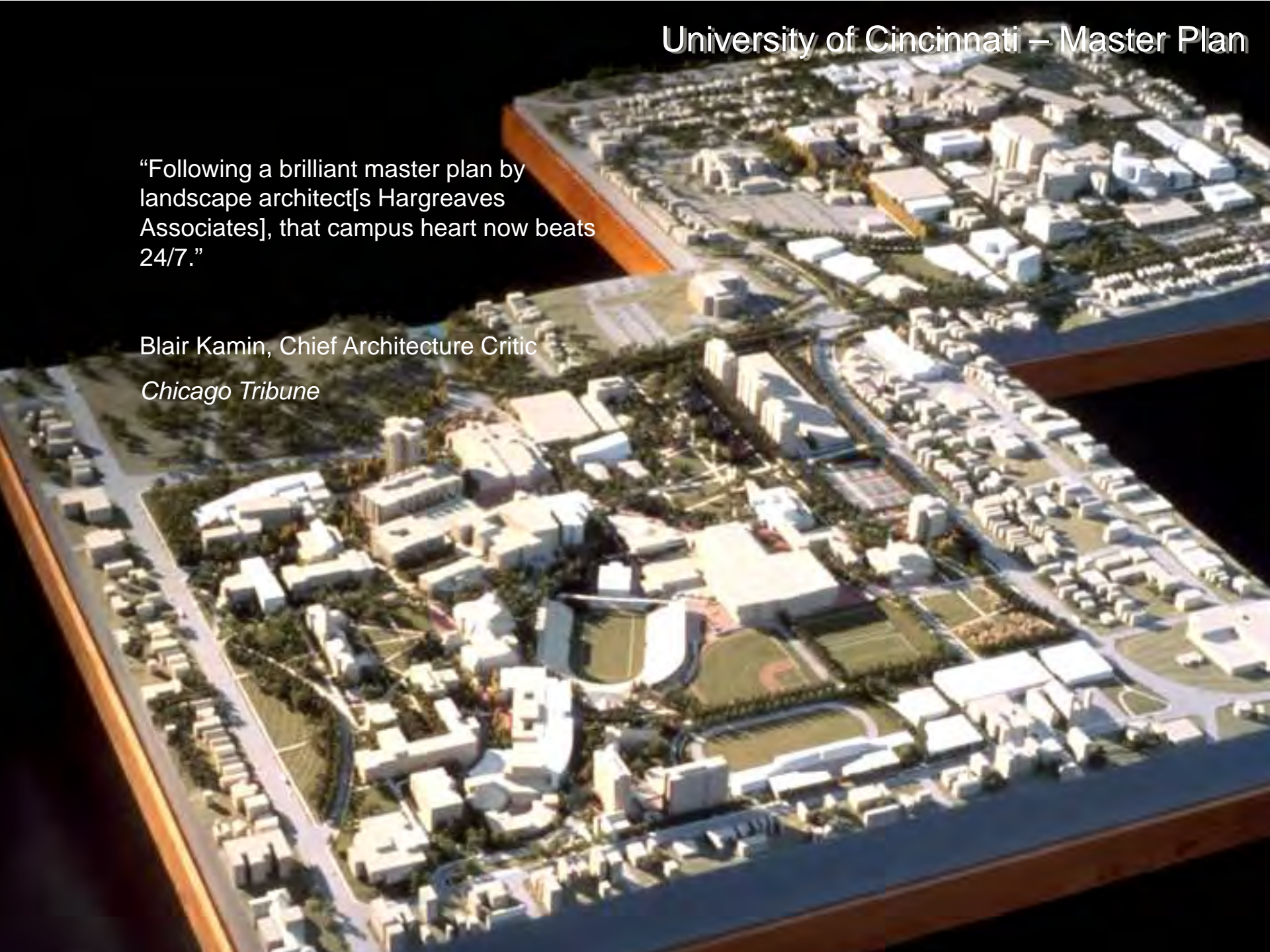



1937





late 1970's 10

p. 98 - 99 SPREAD

160%

1A-

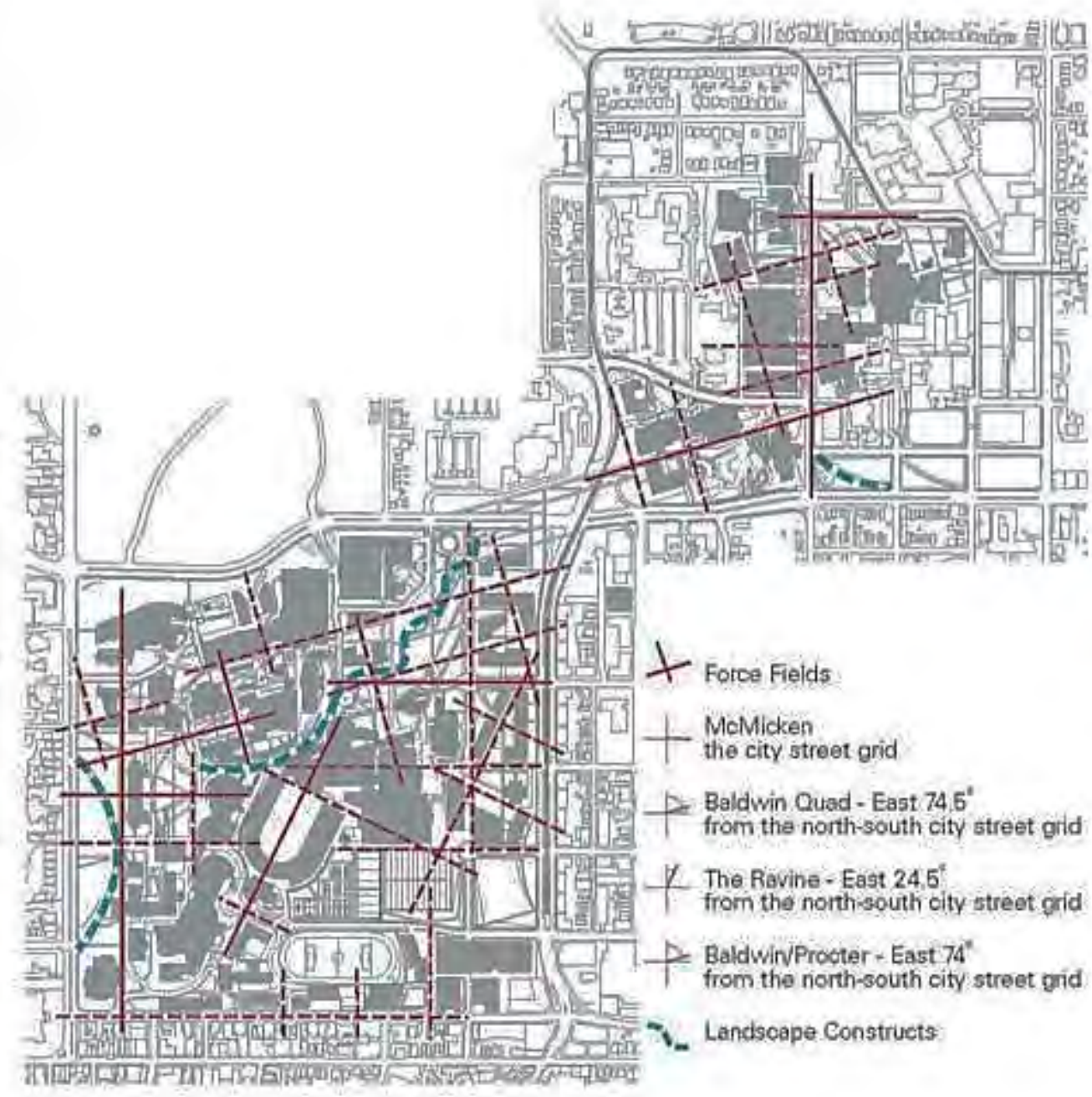

-  Force Fields
-  McMicken  
the city street grid
-  Baldwin Quad - East 74.5°  
from the north-south city street grid
-  The Ravine - East 24.5°  
from the north-south city street grid
-  Baldwin/Procter - East 74°  
from the north-south city street grid
-  Landscape Constructs

















# University of Cincinnati – Campus Green



# University of Cincinnati – Main Street



<b>Colleges and Universities</b>	<b>Institutions</b>	<b>Students</b>
Public 4 Year	595	5,803,000
Public 2 Year	972	4,938,000
Private 4 Year	1,546	2,726,000
Private 2 Year	446	243,000
<b>Total</b>	<b>3,559</b>	<b>13,710,000</b>

## **Students**

Undergraduate	11,863,000
Graduate	1,547,000
Professional	274,000
Vocational	6,455

**Faculty** 379,373 (211,972 tenured)